

SynchroFlex®

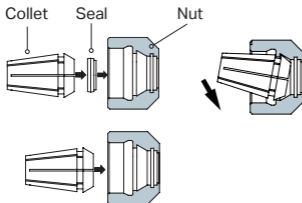

Correct

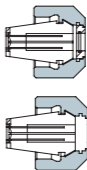

Correct

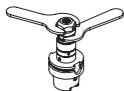

Incorrect



ER-size	Ø mm	Ø inch	Max. torque value	
			Nm	ft-lbs
8	1-5	.039-.196	6	4
11	1-2.9/3-7	.039-.098 / .118-.256	8/16	6/12
20	1.5-6.5/7-13	.059-.256 / .276-.512	32/35	24/26
25	5-17	.196-.669	80	60
40	3-26	.118-1.023	176	130
50	6-36	.236-1.417	300	220

Correct

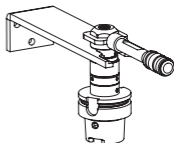

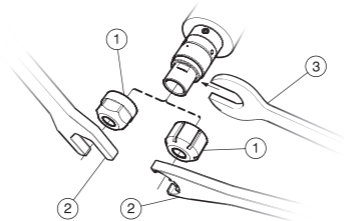

ER size	1. Nut for sealing disc	1. Nut non sealed	2. Wrench ¹⁾	3. Wrench ¹⁾
8		5533 050-09	5680 093-06 ²⁾	5680 093-06 ²⁾
11		5533 050-07	5680 091-03	5680 092-03
20	5533 051-02	5533 050-08	5680 091-02	5680 092-04
25	5533 051-03	5533 050-02	5680 096-02	5680 092-05
40	5533 051-05	5533 050-04	5680 096-04	5680 092-06
50	5533 051-14	5533 050-05	5680 096-05	5680 092-07

¹⁾Accessories, not included.

²⁾Wrench included.



www.sandvik.coromant.com/corochuck970

Head office:
 AB Sandvik Coromant
 SE-811 81 Sandviken, Sweden
www.sandvik.coromant.com
 E-mail: info.coromant@sandvik.com

92044
 © AB Sandvik Coromant
 2020.11